



Chemical Investigations: Keys to Success

Chemical Investigations Section (DOC)
Drug Enforcement Administration (DEA)

LAW ENFORCEMENT SENSITIVE



Table of Contents



Diversion Control Division Overview

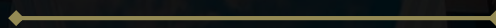

Chemical Sensitive Investigative Units

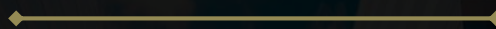

Evidence & Intelligence Collection



Diversion Control Division Overview



LAW ENFORCEMENT SENSITIVE



Mission Statement

The Diversion Control Division's mission is to prevent, detect and investigate the diversion of pharmaceutical controlled substances and listed chemicals from legitimate channels while ensuring an adequate and uninterrupted supply of pharmaceutical controlled substances and listed chemicals to meet legitimate medical, commercial and scientific needs.



DCFA Authority



The Diversion Control Fee Account (DFCA) is a funding mechanism for DEA to regulate the industry and pursue legal action against violators.

Title 21 U.S.C. 821, 886a, and 958 together authorizes DEA, through its Diversion Control Program, to charge reasonable fees to ensure the recovery of the full cost of the various aspects of the program's operation relating to the registration and control of the manufacture, distribution, dispensing, importation, and exportation of controlled substances and listed chemicals.

The DCFA's authority for Schedule I and non-controlled substances extends only to the Investigation of Registrants authorized to handle such substances and scheduling actions.



DCFA Registrants



Defining Registrants:

DEA requires the registration of manufacturers, distributors, and dispensers of controlled substances. There are approximately 1.8 million current registrants.

Registrants must submit an application to the Diversion Control Division

Registrants must pay regular fees to DEA to keep their registration active.

Registrant Fees:

Manufacturers

- Fee: \$3,047
- Renewal Time: 1 year

Distributors

- Fee: \$1,523
- Renewal Time : 1 year

Dispensers

(Doctors/Pharmacists/Hospital)

- Fee: \$731
- Renewal Time: 3 years

Chemical Investigations Section (DOC) supports chemical SIUs in the following 3 countries:

- Mexico
- Colombia
- Peru
- **** Ecuador ****



“The Key to Success”

Evidence & Intelligence
Collection

Evidence Processing

In order to best assist and support a foreign chemical trafficking investigation, DOC needs a variety of intelligence pertaining to the chemicals. This intelligence must be collected and processed at the clandestine laboratories upon seizure.

Samples taken of all chemicals present at the laboratory. Testing results shared and samples sent to DEA if possible.

Photographs of all chemicals: liquids or solids.

Photographs of all labels at the laboratory site, regardless of whether or not they are suspected to be fake or mislabeled.

Details regarding the chemical containers (material, shape, size, quality).

Evidence Processing

Raman Device's that DEA Special Testing Utilizes for Deployments

785 nm



Thermo Scientific
First Defender

785 nm



Thermo Scientific
First Defender
RMX

1064 nm



B&W Tek
TacticID 1064

Evidence Processing

Operation using wand or sample vial

SAMPLE VIAL

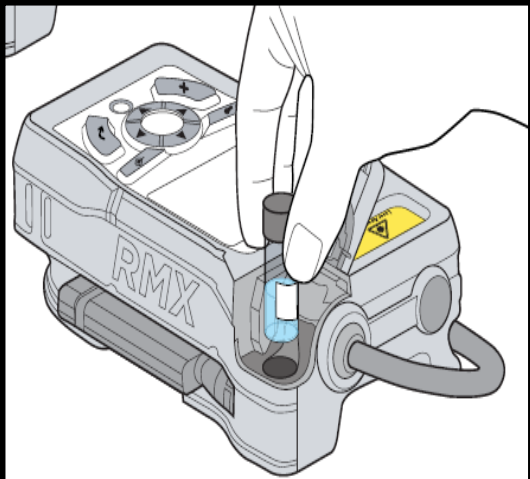

SAMPLE WAND

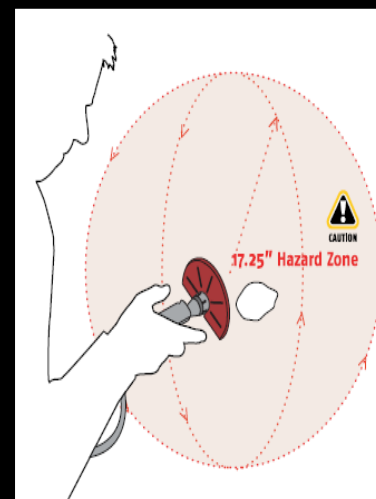

Sample vials are to be filled with disposable pipette (fancy eye dropper) and loaded into instrument as above.

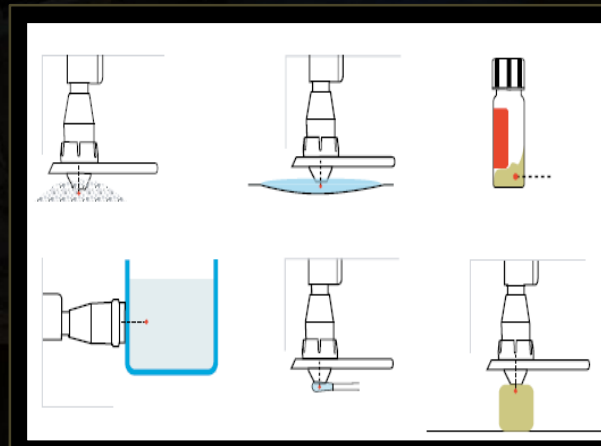

Evidence Processing

Results

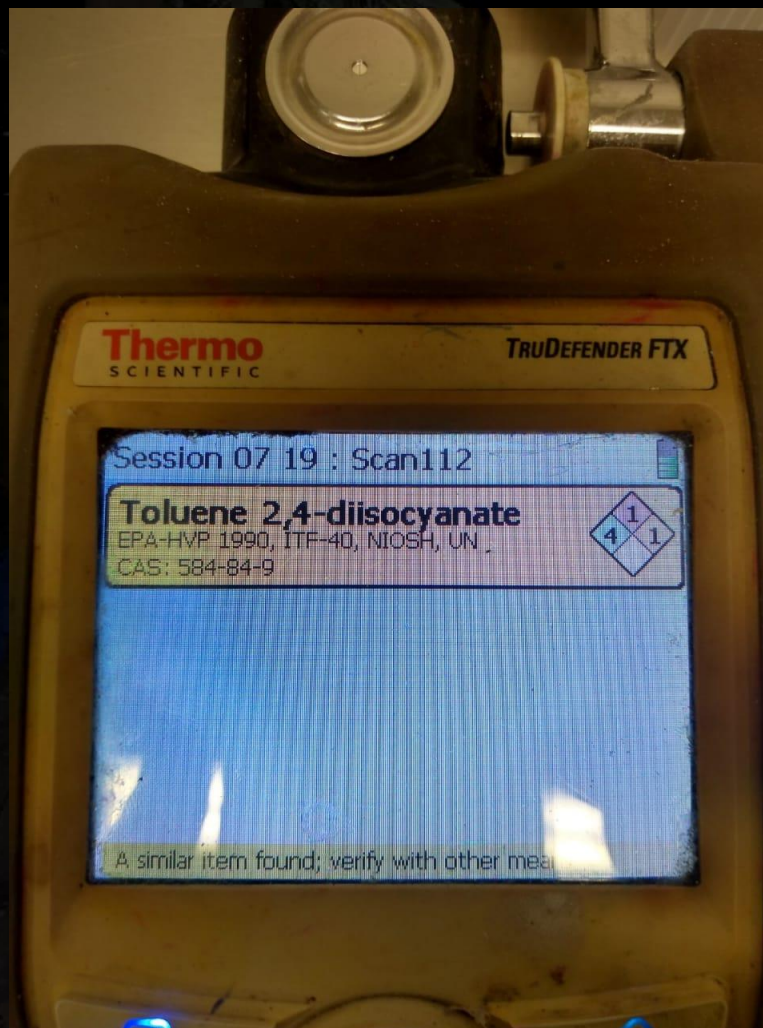

Evidence Processing

SAMPLE VOLUME

1 ounce representative sample taken and submitted to forensic lab:

- If bi-layer, sample each layer separately.
- Check with local forensic lab for requirements of submissions that may be more specific than mentioned here.

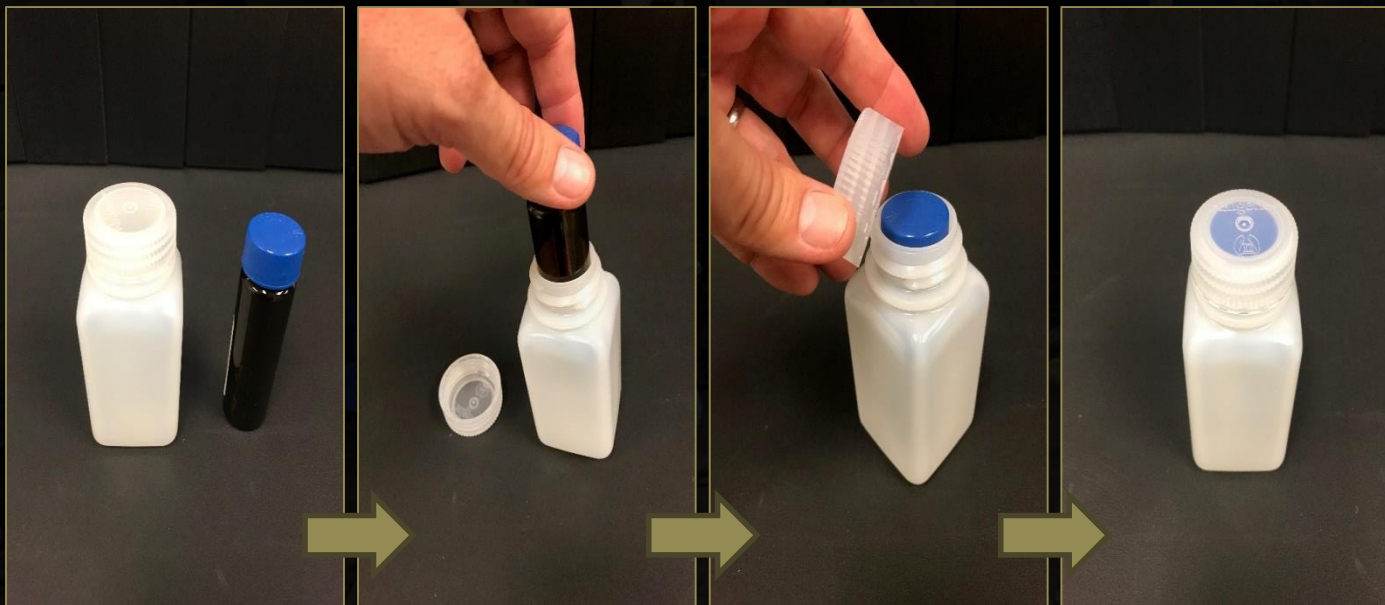

1 fl oz. sample in glass vial with teflon-cap.

Amber glass vial with teflon cap then placed into polycarbonate overpack (Thermo Scientific).

Intelligence from Evidence

This collected evidence can be used by DOC and the respective DEA Country Office in order to potentially reverse engineer the source of the chemicals and determine the point of diversion.

DOC seeks to trace the flow of the chemicals from production to the point of seizure:

Transportation methods used (vehicle, motor vessel, airplane).

Routes taken to move the chemicals.

Mislabeling practices and other potential red flags for suspicious shipments.

Potential key source intelligence that could be identified:

Companies Involved.

Chemical traffickers and brokers.

Corruption at ports of entry.

Mislabeling methods.

Chemical Investigations Section

● Senior Program Analyst John Farmer
202-353-0901
John.F.Farmer@usdoj.gov



LAW ENFORCEMENT SENSITIVE